

SEA WINGS

77



SEVENTY 7
SAILING YACHT



S/V SEAWINGS 77 **(ready to sail no refit needed)**

Registry: CAYMAN ISLANDS ref nb 749571 /Hailing Port Georgetown
Current ownership: Single Asset LLC (Colorado state), no lien

Builder: CNB-LAGOON 77 owner version –
Aft Galley 3 cabins + 1 crew cabin + crew quarter
2 Generators / . 2 water maker / AC /

Model Year 2020. Production: 2019-2020
HIN: IRIZP015A020 CIN CNBZP015A020

HISTORY:

- Delivered in April 2020. Shipped by cargo from France to California in October 2020
- Local sailing in California and Baja Mexico
- Pacific Ocean voyage from California to New Zealand (and returned by cargo)
- Never chartered. Owner operated by a professional crew.

Current location: California, United States



CONFIGURATION

- **OWNER VERSION 3 Cabins / 3 heads**
- **Aft Galley**
- **Crew cabin with bathroom**
- **Crew quarter in Starboard bow**
- **Storage and laundry are in Port bow**



**SPECIAL LAGOON 78
MOTORYACHT
SALOON LAYOUT**



ORIGINAL SPECIFICATIONS

- OWNER 3 CABINS + Crew cabin + captain quarter
- WOOD FINISHING GREY OAK (Grey oak brushed & open grain varnish - Wengé Floor Marble)
- CREW CABIN IN STARBOARD BOW COMPARTMENT (2 bunks, sink, shower, toilet)
HEADS, AFT GALLEY, AND CREW AREA

- FITTED CARPET IN THE CABINS (Except crew area & companion way) - 3 CABINS AFT UPHOLSTERY
AMBIANCE NOMADE - 3 CABINS AFT GALLEY VERSION - NAT PO48 140
- CARPETS OF THE 78 IN THE MAIN SALON
- 3 ELECTRICAL WINCHES IN LIEU OF THE STANDARD CODE 0 DECK GEAR WITH HYDRAULIC FURLER
- CARBON CANOE BOOM WITH LIGHT AND COVER - NOMADE
- SQUARE TOP MAINSAIL & GENOA IN SPECTRA DYS (white sail) 2 AFT MOORING CAPSTANS WITH
PROTECTING LIDS
- 2 SPOT LIGHTS IN AFT BEAM
- BLUE LED UNDERWATER LIGHTS

FLYBRIDGE

- COMPOSITE BIMINI WITH WINDOWS, LIGHTS & PRIVACY CURTAINS - NOMADE (Sunlounger pads)
- FLYBRIDGE FLOOR IN TEAK
- BUILT-IN ELECTRIC GRILL IN THE COCKPIT ICE MAKER 220V ON THE FLYBRIDGE
- BOARDING LADDER
- LED MAST DECORATING LIGHTS (Aluminium Mast)
- EXTERIOR CUSHIONS WITH PROTECTION COVERS - NOMADE (Aft & Forward Cockpits) ROSEN GREY
- ICE MAKER 220V IN THE COCKPIT
- KIT OF COVERS NOMADE (Steering wheels, NavStations, Cockpit table, Flybridge tables, Windlass) With
Sunlounge pads
- RETRACTABLE HYDRAULIC GANGWAY ON PORTSIDE TRANSOM (3,50m)
- HYDRAULIC AFT PLATFORM (1 FOLDING SIDE) WITH REMOTE FORWARD COCKPIT SUN AWNING WITH
CARBON POSTS – NOMADE
- ENCLOSURE WITH WINDOWS FOR FLYBRIDGE COMPOSITE BIMINI - NOMADE AFT COCKPIT
ENCLOSURES WITH WINDOWS AND PRIVACY CURTAINS – NOMADE
- ROPE CUTTERS ON THE PROPELLER SHAFTS FOLDING PROPELLERS FOR JOHN DEERE N5-230 HP
ENGINES 2 x 230 HP (JOHN DEERE N5-230)
- ELECTRICAL BOW THRUSTER ON STBD SIDE WITH DEDICATED BATTERIES BANK (Side Power 340 Kg)
- EXTRA FOR ELECTRONIC ENGINE THROTTLES AT CHART TABLE AND PORT NAV. STATION WITH
ELECTRONIC INTERFACE (JOHN DEERE N5-230 HP)
- ADDITIONAL GENSET ONAN 19 Kva 1500rpm 220V/50HZ + COCOON MANAGEMENT MONITORING
SYSTEM

- PACK 2 CHARGERS 220V 100 Amp
- PACK 2 INVERTERS 24/220V 5000 W - WITH YACHT MANAGEMENT MONITORING SYSTEM EXTRA FOR GENSET UPGRADE ONAN 27Kva 1500rpm 220V/50HZ + COCOON
- - YACHT MANAGEMENT MONITORING SYSTEM
- YACHT MANAGEMENT MONITORING SYSTEM ON B&G DISPLAYS
- WATERMAKER 280L/H SEA RECOVERY AQUAMATIC 220V - WITH YACHT MANAGEMENT SYSTEM
- FRESHWATER PURIFIER IN AFT GALLEY SINK CRUSHER IN THE GALLEY
- WINE CELLAR OF 78 (22 bottles) IN THE SALON TOSCA CHAIRS (LINEN) IN THE SALOON
- REVERSE CYCLE CHILLED WATER AIR CONDITIONING 180 000 BTU WITH ELECTRICAL MONITORING
- GLENDINNING REEL FOR SHOREPOWER CABLE - 3 CABINS AFT GALLEY
- REVERSE CYCLE CHILLED WATER AIR CONDITIONING STARBOARD BOW COMPARTMENT
- MICROWAVE OVEN + GRILL 220V Miele
- ICE MAKER 220V IN THE SALOON DISHWASHER 220V MIELE 12 sets
- ELECTRICAL AFT PORT COMPANIONWAY DOOR (in lieu of standard)
- FRIDGE (80 liters) IN THE SALOON
- ELECTRICAL ROLLER BLINDS IN THE SALON 2 B&G CAMERAS UNDER FLYBRIDGE
- B&G M324-XP NIGHT VISION CAMERA IN ALUMINIUM MAST B&G 12" DISPLAY IN CREW AREA - AFT GALLEY
- B&G FISH FINDER DIGITAL SOUNDER
- HIFI ATOLL (2 loudspeakers) + TV 110V PREFITTING WITH ELECTRIC LIFT - FORWARD PORT CABIN
- HIFI ATOLL (2 loudspeakers) + TV 110V PREFITTING WITH ELECTRIC LIFT - OWNER'S CABIN HIFI ATOLL (2 loudspeakers) + TV 110V PREFITTING WITH SUPPORT - AFT STARBOARD CABIN HIFI ATOLL (2 loudspeakers) + TV 110V PREFITTING WITH BRACKET - AFT PORT GALLEY
- B&G NAVIGATION PACK (VHF + RADAR + AIS + 2 Nav charts included) B&G FORWARD SCAN SOUNDER
- ATOLL HIFI MEDIA CENTER SOUND SYSTEM + TV 110V PREFITTING IN THE SALON & OUTSIDE AREAS + THE CABINS (Salon: 4 loudspeakers + subwoofer; Aft & Fwd cockpits + fly: 2 loudspeakers each - Touch screen)
- AUTOPILOT REMOTE SMARTCONTROL
- NORTH AMERICAN SPECIFICATIONS - 3 CABINS AFT GALLEY
- SPECTRA DYS STAYSAIL + RUNNING RIGGING & HALYARD + HYDRAULIC FURLER
- LAYOUT WITH SUNPADS ON FLYBRIDGE WITHOUT CENTRAL PART SALON LAYOUT L78 FOR 77 WITHOUT CHAIR
- WASHING MACHINE AND DRYER IN BOW PORTSIDE FOREPEAK
- TV SAT V7 PRE INSTALLATION: HD7 ANTENNA WITHOUT US DECODER - RADOME SAME SIZE AS TRACKPHONE V7 HTS. CABLES FOR THE 3 CABINS + SALOON + GALLEY
- 3 TOSCA CHAIRS INSIDE COCKPIT L77 TOSCA LINEN
- TOSCA CHAIRS LINEN ON FLYBRIDGE NOMADE UPHOLSTERY FOR SUNLOUNGER PA

AFTER MARKET and Recent upgrades

Full paint AWLGRIP Done in March 2021

- Spectra Catalina (2nd) Water maker
- 2x 600 Watt Watt and Sea Hydro-generators pods.
- Ultra 80kg anchor and flip swivel
- 2x 150-gallon additional stainless fuel tanks
- Code zero sail
- carbon fiber wheels
- new sail cover
- Custom build barbecue in aft cockpit



AERIAL VIEWS







FLYBRIDGE







AFT COCKPIT



AFT SALOON



FRONT SALOON

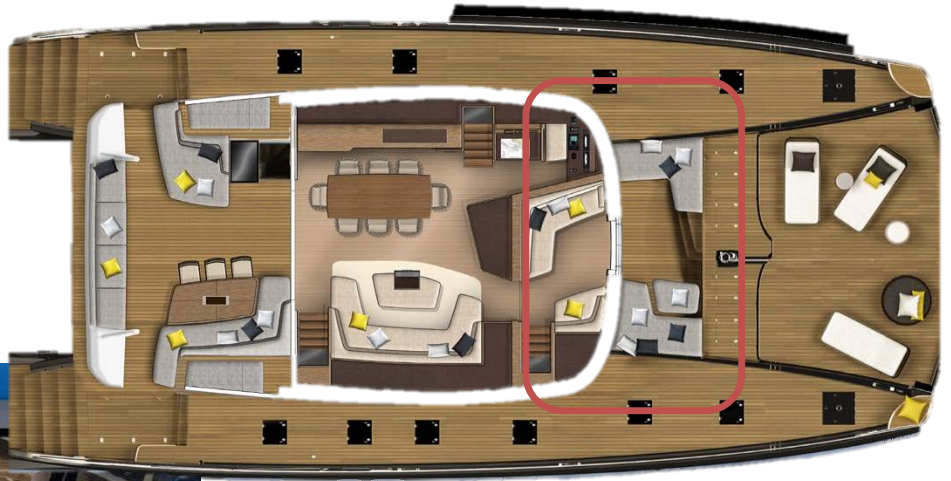

AFT GALLEY (port)

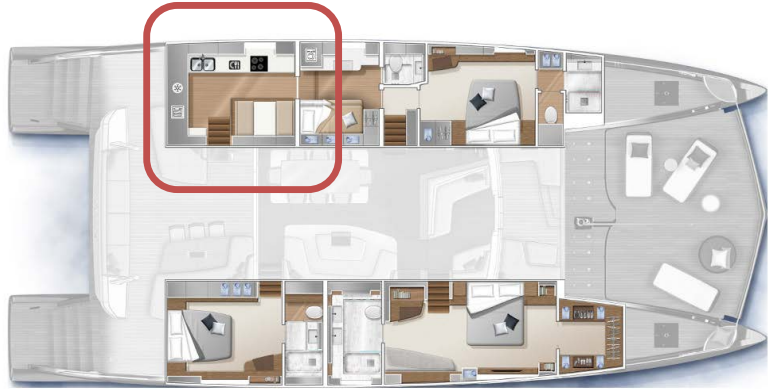

CREW CABIN

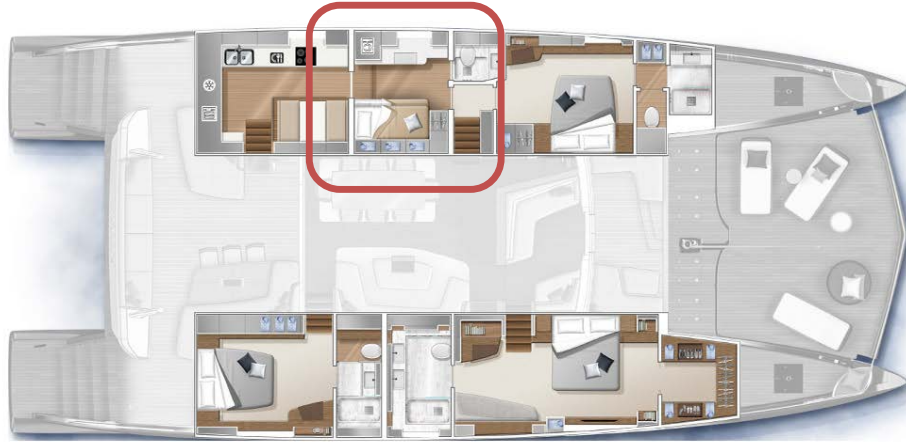

GUEST CABIN (port Forward)



MASTER OWNER CABIN (port Forward)







VIP CABIN (aft Starboard)





PORT STORAGE CABIN

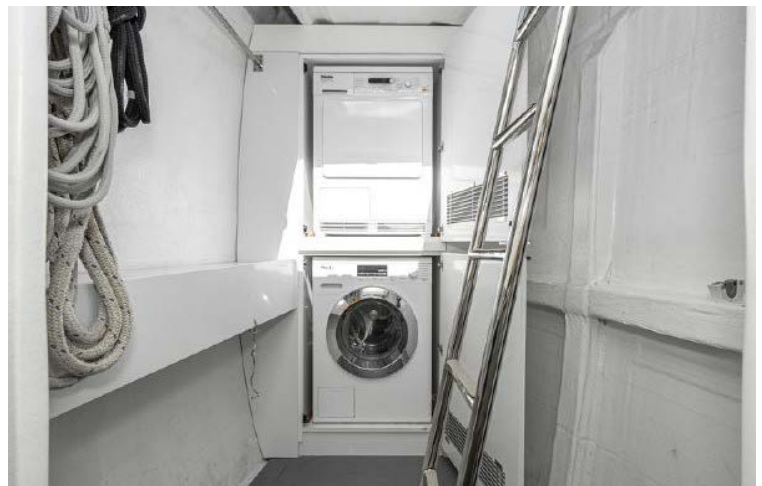

STARBOARD CREW CABIN



ENGINE ROOM



Engine: JOHN DEERE N5.230 HP

PORT Engine n° JAF19090032 / Gearbox n°20351476 – 1200 hours

STB Engine n° JAF19090031 / Gearbox n°20351477 – 1200 hours



